

# Installation Manual

SK-2732  
ARNOTT FRONT SHOCK KIT  
FOR 2002-2009  
LEXUS GX-470 (TOYOTA PRADO)



Congratulations on your purchase of an Arnett® air suspension product. We at Arnett Incorporated are proud to offer a high quality product at the industry's most competitive pricing. Thank you for your confidence in us and our product.

Proper installation is essential to experience and appreciate the benefits of this system. Please take a moment to review these installation instructions before you begin to install these components on your vehicle. The removal and installation of air suspension products should only be performed by a fully qualified, ASE Certified, professional.

It is equally important to be aware of all necessary safety measures while installing your new Air Suspension System. This includes proper lifting and immobilizing of the vehicle and isolation of any stored energy to prevent personal injury or property damage.

## "Engineered to Ride, Built to Last®"



**WARNING:** *The air suspension system is under pressure (up to 10 bar, or 150 lbf/in). Verify pressure has been relieved and disconnect power to the air suspension system prior to disassembly. Do not allow dirt or grease to enter the system. Always wear standard hand, ear, and eye protection when servicing the air suspension system.*

Arnett® is committed to the quality of its products. If you have a question or problem with any Arnett product, please contact Arnett by calling [800-251-8993](tel:800-251-8993) during normal business hours or email [techassistance@arnottinc.com](mailto:techassistance@arnottinc.com).

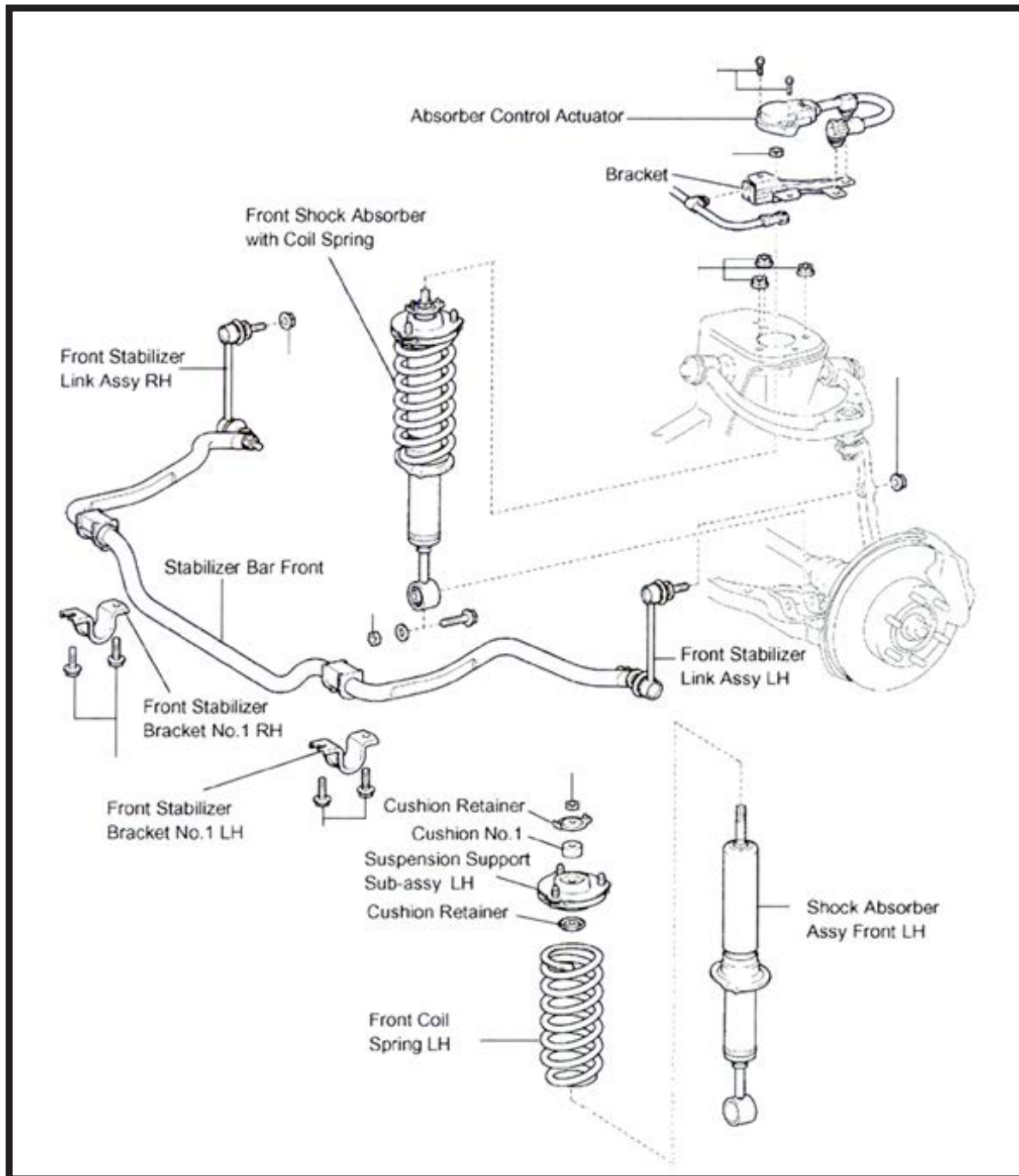

## GENERAL INFORMATION:

Reading this manual signifies your agreement to the terms of the general release, waiver of liability, and hold harmless agreement, the full text of which is available at [www.arnottinc.com](http://www.arnottinc.com).

- Not to be stored below 5°F (-15°C) or above 122°F (50°C).
- Avoid damage to air lines and cables.
- Removal and installation is only to be performed by fully qualified personnel.
- Use car manufacturer's diagnostic software.

**CAUTION:** Damage to the vehicle and air suspension system can be incurred if work is carried out in a manner other than specified in the instructions or in a different sequence.



To avoid the possibility of short circuits while working with electric components consult your owner's manual on how to disconnect your battery.



Consult your vehicle owner's manual, service manual, or car dealer for the correct jacking points on your vehicle and for additional care, safety and maintenance instructions. Under no circumstances should any work be completed underneath the vehicle if it is not adequately supported, as serious injuries and death can occur.

## COIL STRUT REMOVAL

1. SAFELY RAISE AND SUPPORT THE VEHICLE.
2. REMOVE THE WHEEL AND TIRE ASSEMBLY.
3. DISCONNECT THE FRONT STABILIZER LINK ASSEMBLY BY REMOVING THE NUT AND DISCONNECT THE STABILIZER LINK FROM THE STEERING KNUCKLE. (FIGURE A)

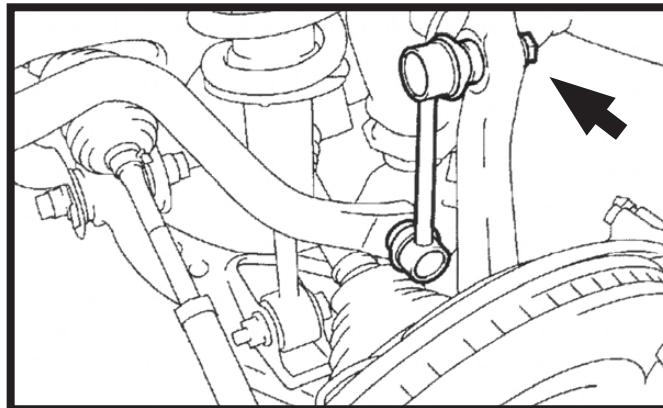

FIGURE A

4. REMOVE FRONT STABILIZER BRACKET(S), BOTH LEFT AND RIGHT SIDES. (FIGURE B)

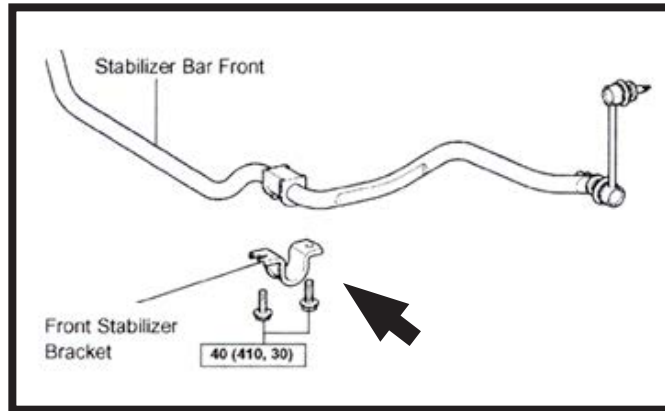

FIGURE B

5. REMOVE STABILIZER BAR FRONT.
6. DISCONNECT THE 3 CLAMPS, CONNECTOR AND THE TWO RETAINING BOLTS OF THE ABSORBER CONTROL ACTUATOR. (FIGURE C)

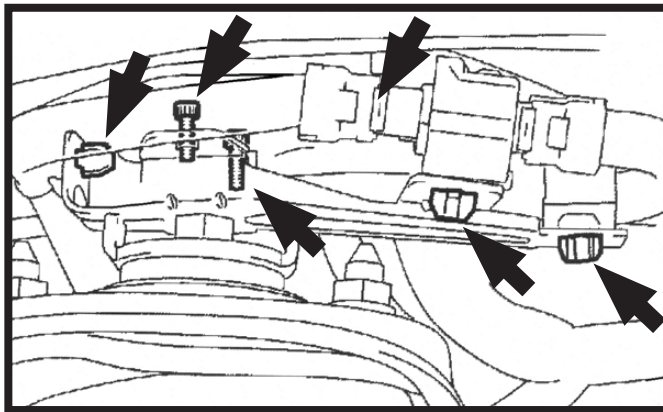

FIGURE C

7. REMOVE THE NUT AND BRACKET. (FIGURE D)

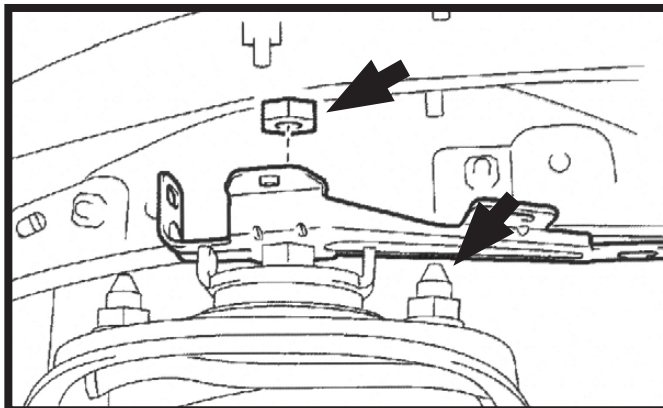

FIGURE D

8. REMOVE THE LOWER SHOCK MOUNTING NUT, WASHER, AND BOLT. (FIGURE E)

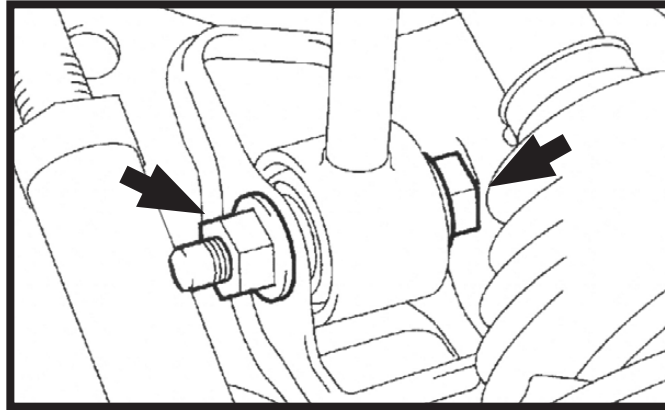

FIGURE E

9. REMOVE THE THREE NUTS ON THE UPPER SIDE OF THE SHOCK ABSORBER WITH COIL SPRING. (FIGURE F)

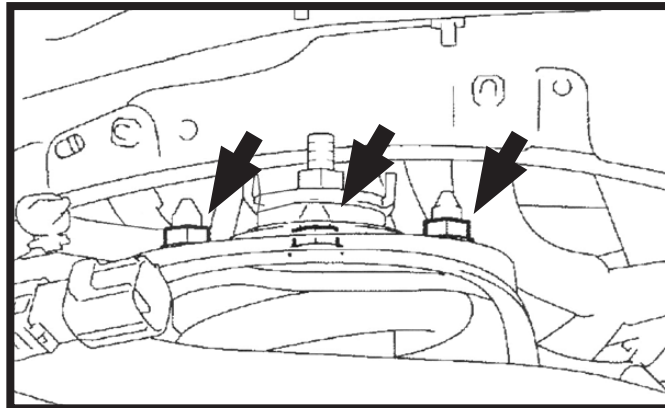

FIGURE F

10. REMOVE THE SHOCK ABSORBER WITH COIL SPRING.

## SHOCK REMOVAL

11. USING A COIL COMPRESSOR COMPRESS THE COIL. (FIGURE G)

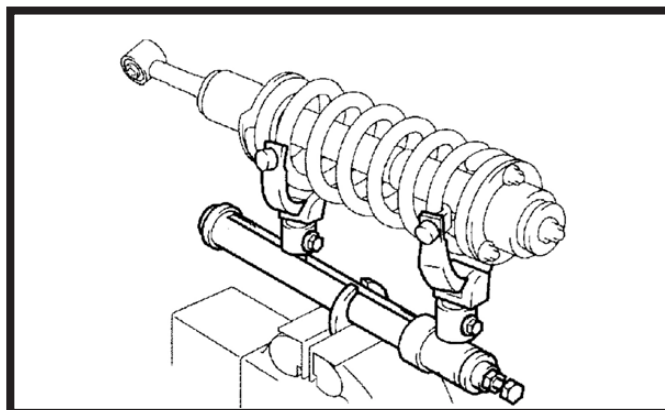

FIGURE G

12. HOLD THE SHOCK ABSORBER AND REMOVE THE NUT. (FIGURE H)

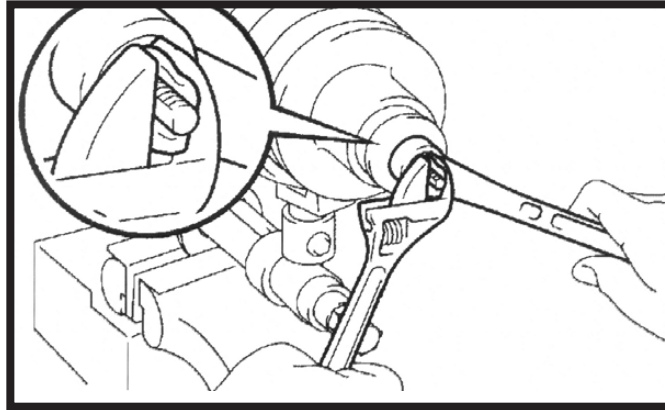

FIGURE H

13. REMOVE THE CUSHION RETAINER, CUSHION NO. 1, SUPPORT SUB ASSEMBLY, CUSHION RETAINER AND THE FRONT COIL. (FIGURE I)

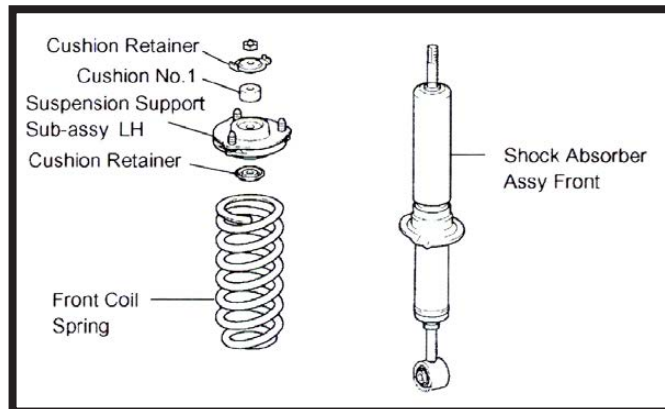

FIGURE I

14. REMOVAL COMPLETE.

## SHOCK INSTALLATION



*Tighten all nuts and bolts to manufacturer's specifications during the installation process.*

1. INSTALLATION IS IN REVERSE ORDER OF SHOCK REMOVAL.

## COIL SPRING INSTALLATION



*Tighten all nuts and bolts to manufacturer's specifications during the installation process.*

1. INSTALLATION INTO THE VEHICLE IS IN REVERSE ORDER OF COIL STRUT REMOVAL