

Installation Manual

SK-2716 ARNOTT BILSTEIN FRONT SHOCK KIT FOR 2001-2006 AUDI ALLROAD



Congratulations on your purchase of an Arnott® air suspension product. We at Arnott Incorporated are proud to offer a high quality product at the industry's most competitive pricing. Thank you for your confidence in us and our product.

Proper installation is essential to experience and appreciate the benefits of this system. Please take a moment to review these installation instructions before you begin to install these components on your vehicle. The removal and installation of air suspension products should only be performed by a fully qualified, ASE Certified, professional.

It is equally important to be aware of all necessary safety measures while installing your new Air Suspension System. This includes proper lifting and immobilizing of the vehicle and isolation of any stored energy to prevent personal injury or property damage.

"Engineered to Ride, Built to Last™"



WARNING: The air suspension system is under pressure (up to 10 bar, or 150 lbf/in). Verify pressure has been relieved and disconnect power to the air suspension system prior to disassembly. Do not allow dirt or grease to enter the system. Always wear standard protective hand, ear, and eye protection when servicing the air suspension system.

KIT CONTAINS:

PARTS LIST

P/N	QTY	DESCRIPTION
21-7100	1	ARNOTT BILSTEIN FRONT SHOCK KIT
21-7099	1	ACCESSORY KIT

Arnott® is committed to the quality of its products. If you have a question or problem with any Arnott product, please contact Arnott by calling **800-251-8993** during normal business hours or email techassistance@arnottinc.com

GENERAL INFORMATION:

Reading this manual signifies your agreement to the terms of the general release, waiver of liability, and hold harmless agreement, the full text of which is available at www.arnottinc.com.

- Not to be stored below 5°F (-15°C) and above 122°F (50°C).
- Avoid damage to air lines and cables.
- Removal and installation is only to be performed by fully qualified personnel.
- Use car manufacturer's diagnostic software.

CAUTION: Damage to the vehicle and air suspension system can be incurred if work is carried out in a manner other than specified in the instructions or in a different sequence.



To avoid the possibility of short circuits while working with electric components consult your owner's manual on how to disconnect your battery.



Consult your vehicles owners manual, service manual, or car dealer for the correct jacking points on your vehicle and for additional care, safety and maintenance instructions. Under no circumstances should any work be completed underneath the vehicle if it is not adequately supported, as serious injuries and death can occur.

AIR STRUT REMOVAL

1. SET STEERING TO STRAIGHT AHEAD.
2. RAISE VEHICLE.
3. REMOVE FRONT WHEEL.
4. BEGIN BY FIRST REMOVING THE LOWER SHOCK RETENTION NUT AND BOLT. (FIGURE A)

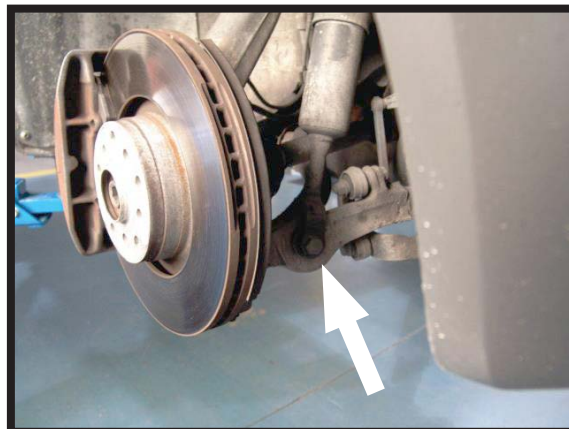

FIGURE A

5. NEXT REMOVE THE UPPER CONTROL ARM PINCH BOLT WHICH HOLDS THE TWO BALL JOINTS TO THE SPINDLE ASSEMBLY. (FIGURE B)

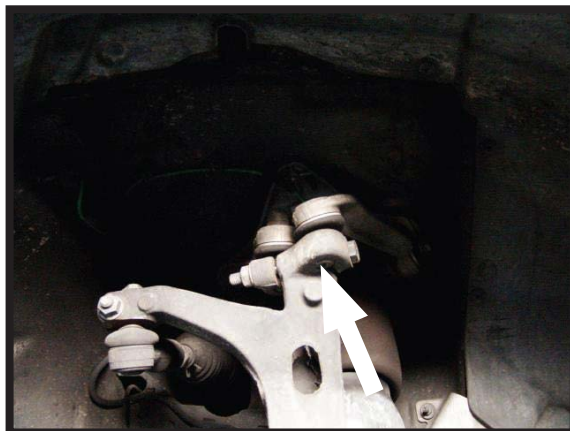

FIGURE B

6. REMOVE THE THREE BOLTS HOLDING THE UPPER MOUNT TO THE BODY. (FIGURE C)



FIGURE C

7. REMOVE THE AIR STRUT ASSEMBLY FROM THE VEHICLE. (FIGURE D)



FIGURE D

8. LOOSEN AND REMOVE THE SIX BOLTS HOLDING THE AIR STRUT TO THE UPPER MOUNT. (FIGURE E)



FIGURE E

9. SEPARATE THE UPPER MOUNT FROM THE AIR STRUT. (FIGURE F)



FIGURE F

AIR SPRING REMOVAL

10. IMPACT THE NUT FROM THE SHOCK ROD END AND REMOVE THE UPPER RUBBER MOUNT. (FIGURE G)



FIGURE G

11. REMOVE THE AIR SPRING FROM THE FACTORY SHOCK BEING SURE TO SAVE THE LOWER O-RING. (FIGURE H)



FIGURE H

AIR SPRING INSTALLATION



Tighten all nuts and bolts to manufacturer's specifications during the installation process.

1. INSTALLATION IS IN REVERSE ORDER OF AIR SPRING REMOVAL.

FACTORY AIR SPRING

ARNOTT AIR SPRING

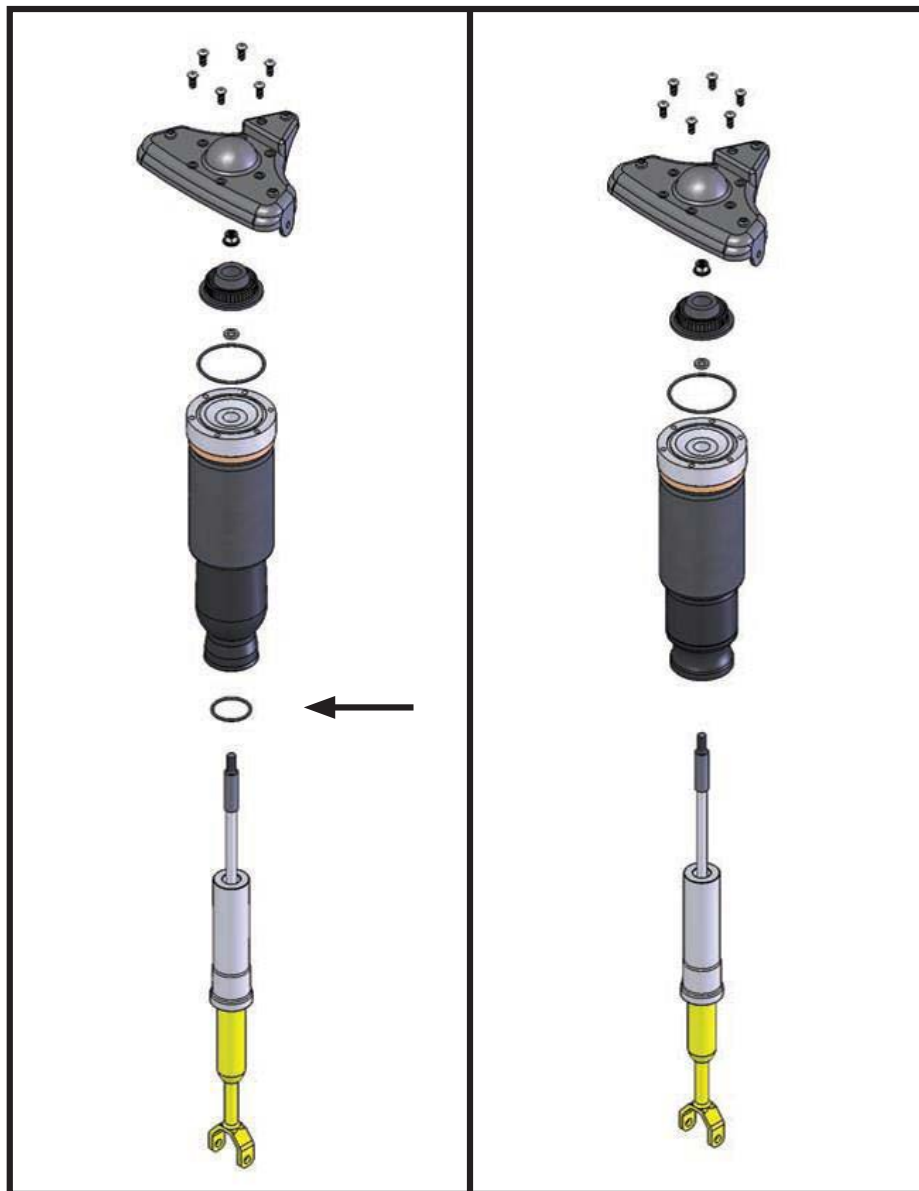

NOTE:

WHEN INSTALLING WITH A FACTORY AIR SPRING, REUSE THE FACTORY LOWER O-RING.

REASSEMBLE AS INDICATED. REINSTALL INTO VEHICLE IN THE REVERSE ORDER OF DISASSEMBLY.

AIR STRUT INSTALLATION



Tighten all nuts and bolts to manufacturers specifications during the installation process.

1. INSTALLATION IS IN REVERSE ORDER OF AIR STRUT REMOVAL.