



Congratulations on your purchase of an Arnott air suspension product. We at Arnott Incorporated are proud to offer a high quality product at the industry's most competitive pricing. Thank you for your confidence in us and our product.

Proper installation is essential to experience and appreciate the benefits of this system. Please take a moment to review these installation instructions before you begin to install these components on your vehicle.

It is equally important to be aware of all necessary safety measures while installing your new Air Ride Suspension. This includes proper lifting and immobilizing of the vehicle and isolation of any stored energy to prevent personal injury or property damage.

*“Engineered to Ride, Built to last”*



**WARNING:** *The air suspension system is under pressure (up to 10 bar, or 150 lbf/in ) verify pressure has been relieved and disconnect power to the air ride system prior to disassembly. Do not allow dirt or grease to enter the system. Always wear standard protective hand, ear, and eye protection when servicing the air suspension system.*

**Kit Contains:**

PARTS LIST		
P/N	QTY	DESCRIPTION
29-4121	2	SHOCK ABSORBERS, FRONT
21-5126	2	SHOCK ABSORBERS, REAR
29-5072	2	REAR COIL SPRINGS
21-6533	1	ACCESSORY KIT

**Additional hardware needed, not supplied- hardware to cap the AHC lines.**



*\*Removal and installation is only to be performed by fully qualified personnel.*

*\*CAUTION: Damage to the vehicle and shock assembly can be incurred if work is carried out in a manner other than specified in the instructions or in a different sequence.*

### COIL SPRING AND REAR SHOCK ABSORBER REMOVAL/INSTALLATION:

#### Kit Contains:

PARTS LIST		
P/N	QTY	DESCRIPTION
21-5126	2	REAR AIR SHOCK
29-5072	2	REAR COIL SPRINGS



21-5126



29-5072

#### Air Shock Removal/Installation:



*The ignition must remain switched off during the shock removal and replacement.*



*Use lifting platform (hoist) that is capable of raising the body separately from the wheels, lift body at the lifting points prescribed by the vehicle manufacturer.*

*Vehicle slippage can cause danger to life and limb.*

- 1.0 Raise vehicle.
- 2.0 Remove rear tires.

**NOTE:** Refer to Figure B for steps 3.0- 9.0 (air shock removal and installation).

- 3.0 Disconnect the shock sensor connector at the top of the shock (1) (Removal only).
- 4.0 Disconnect the air line by turning clip 90°. Locate and disconnect ride height sensor.



- 5.0 Remove the upper air shock nut and bolt.
- 6.0 Disconnect brake line which is bolted to rear axle differential.
- 7.0 Disconnect sway bar and link. Have a floor jack under axle.
- 8.0 Remove the lower air shock nut and bolt.
- 9.0 Remove air shock, (Install Spring before completing shock Install).
- 10.0 Removal complete, installation is in the reverse order of removal. Install upper shock bolt, and allow shock to hang until spring installation is complete. Torque shock bolts to manufacturer's specification.

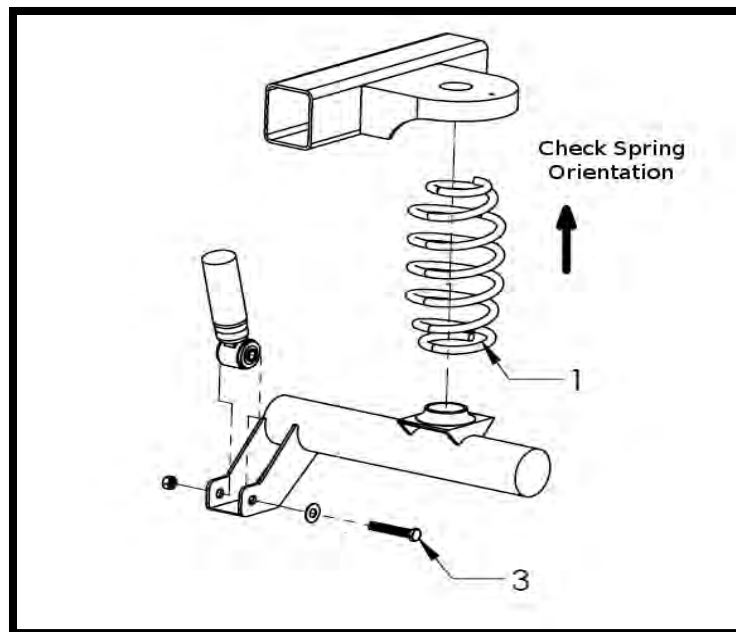

FIGURE B



### Coil Spring Installation:

- 1.0 Install the coil springs onto the rear axle.
- 2.0 Using a floor jack raise the rear axle.
- 3.0 Install the lower shock absorber retaining nut and bolt to the rear axle. Tighten the lower shock absorber retaining nut and bolt to manufacturer's specification.
- 4.0 Replace tire and wheel assembly. Tighten wheel hub bolt nuts to manufacturer's specifications.
- 5.0 Remove all safety stands and lower vehicle.



**WARNING:** Make sure to tighten all wheel hub bolt nuts to manufacturer's specification. Failure to heed to this warning could result in vehicular damage and serious bodily injury.



## Front Shock Installation:



**WARNING:** Before disassembling the front suspension refer to the vehicle remanufacturer's Service Manual for proper procedures. Failure to heed to this warning could result in vehicular damage and serious bodily injury.

PARTS LIST		
P/N	QTY	DESCRIPTION
29- 4121	2	SHOCK ABSORBERS, FRONT



29- 4121

## Removal:

- 1.0 Raise and support the vehicle.
- 2.0 If equipped with selectable ride, disconnect the Real Time Damping (RTD) link rod from the sensor. Grasp the connector lock tabs. Rotate the connector lock tabs (1) and (2) counter-clockwise until the connector is unlocked. Disengage the connector from the tennon by firmly pulling the connector up. Hold the tennon end with a wrench while removing the nut. Remove the nut.

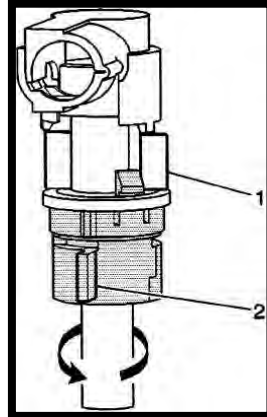

FIGURE 10-2

- 3.0 Remove the upper insulator.
- 4.0 Remove the shock absorber mounting bolts at the lower control arm. Remove the shock absorber through the lower control arm from below. (FIGURE 10-3)

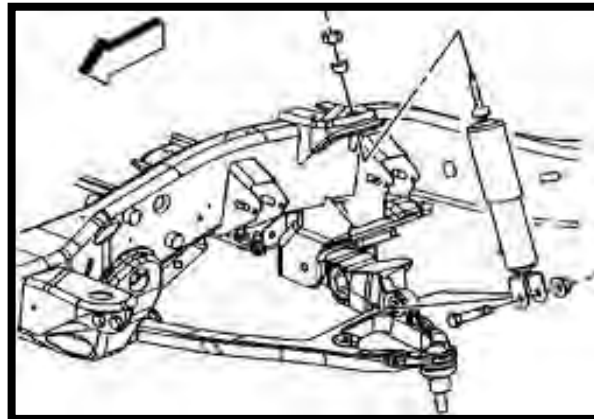

FIGURE 10-3

**Installation:**

- 1.0 Support the lower control arm with a suitable jack in order to align the tennon with the mounting hole if equipped with selectable ride.
- 2.0 Install shock absorber through the lower control arm from below .
- 3.0 Connect tennon through the mounting hole in the upper spring pocket .
- 4.0 Align the shock absorber with the mounting hole in the lower control arm.
- 5.0 Install shock absorber mounting bolt to the lower control arm. Tighten to manufacturer's specifications.



- 6.0 Connect upper insulator to the shock absorber.
- 7.0 Install nut to the tennon end. Do not tighten the nut.
- 8.0 Remove the safety stands.
- 9.0 Lower the vehicle. Hold the tennon end with a wrench while torquing the nut. Tighten the nut to manufacturer's specifications.

**SPOOFER INSTALLATION:**

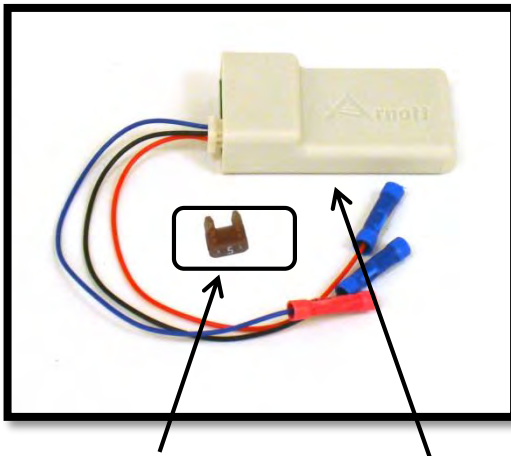

29-5138

21-5127

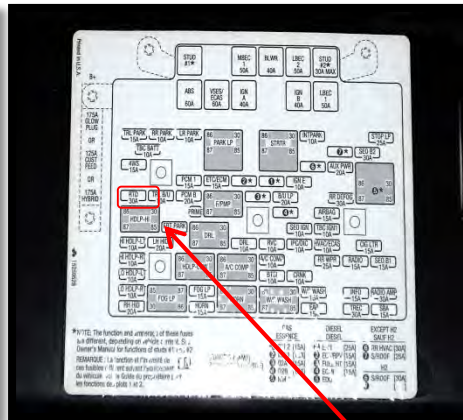

29-5138 (FUSE 5 A)



PARTS LIST		
P/N	QTY	DESCRIPTION
21-5127	1	SPOOFER
29-5138	1	FUSE 5 A

- 1.0 REMOVE (3) CONNECTORS FROM AIR RIDE CONTROLLER. (FIGURE A)
- 2.0 CUT ORANGE AND BLACK WIRES (PINS "D" AND "E"), FROM GREY CONNECTOR. (FIGURE B)



FIGURE A

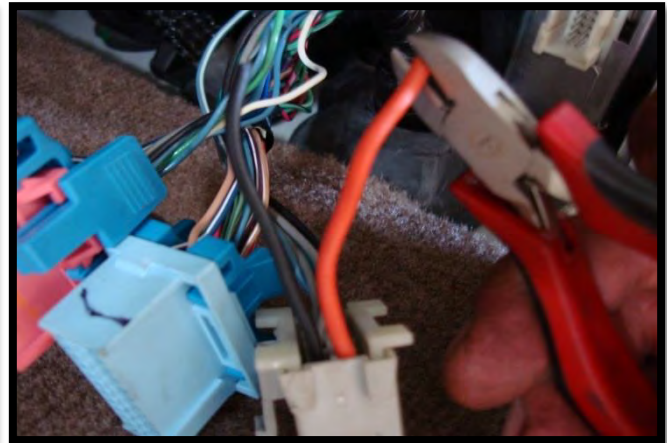



FIGURE B

2.0 LOCATE PIN B-8 ON PINK 24 PIN CONNECTOR AND CUT WIRE.  
(FIGURE C)

3.0 CONNECT TO THE **WIRING HARNESS SIDE!** (CHART10-4) (FIGURE D)

SPOOFER SIDE	FROM	TO	WIRING HARNESS SIDE
			
	BLUE	BLUE	
	RED	ORANGE	
	BLACK	BLACK	

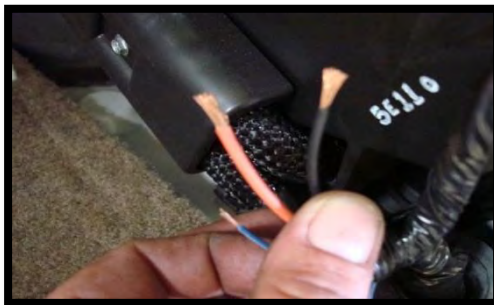

FIGURE C

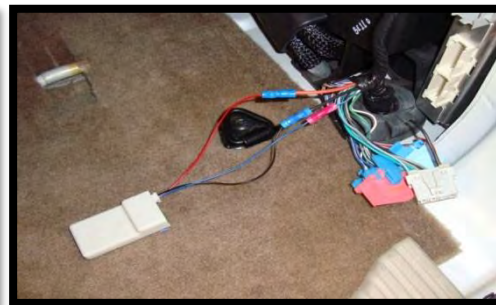

FIGURE D





4.0 CONTROLLER (FIGURE E)

5.0 CONTROLLER I.D. PLATE (FIGURE F)

6.0 DO **NOT** RECONNECT AIR RIDE CONTROLLER!

8.0 REPLACE FACTORY 25 A FUSE WITH SUPPLIED 5 A FUSE.



FIGURE E



FIGURE F