



A-2252  
2001-2005 AUDI ALLROAD  
REAR AIR SPRING ASSEMBLY



Congratulations on your purchase of an Arnett air suspension product. We at Arnett Incorporated are proud to offer a high quality product at the industry's most competitive pricing. Thank you for your confidence in us and our product.

Proper installation is essential to experience and appreciate the benefits of this system. Please take a moment to review these installation instructions before you begin to install these components on your vehicle.

It is equally important to be aware of all necessary safety measures while installing your new Air Suspension System. This includes proper lifting and immobilizing of the vehicle and isolation of any stored energy to prevent personal injury or property damage.

*“Engineered to Ride, Built to last”*



**WARNING**

*The air suspension system is under pressure (up to 10 bar, or 150 lbf/in ) verify pressure has been relieved and disconnect power to the air ride system prior to dis-assembly. Do not allow dirt or grease to enter the system. Always wear standard protective hand, ear, and eye protection when servicing the air suspension system.*

Kit contains:

PARTS LIST		
P/N	QTY	DESCRIPTION
21-3807	2	REAR AIR SPRING ASSEMBLY
21-4704	1	ACCESSORY KIT



### General information:

- \* *Not to be stored below 5 °F (-15 °C) and above 122 °F (50 °C).*
- \* *Avoid damage to air lines and cables.*
- \* *Removal and installation is only to be performed by fully qualified personnel.*
- \* *Use car manufacturer's diagnostic software.*
  
- \* **CAUTION:** *Damage to the vehicle and shock assembly can be incurred if work is carried out in a manner other than specified in the instructions or in a different sequence.*

### REAR SHOCK REMOVAL:

**NOTE:** REMOVAL AND INSTALLATION IS FOR BOTH OF THE REAR AIR SPRING.



*The ignition must remain switched off during the shock removal and replacement.*

1.0 SET STEERING TO STRAIGHT AHEAD.



*Use lifting platform (hoist) that is capable of raising the body separately from the wheels, lift body at the lifting points prescribed by the vehicle manufacturer. Vehicle slippage can cause danger to life and limb.*

2.0 RAISE VEHICLE.

3.0 REMOVE REAR TIRE(S).

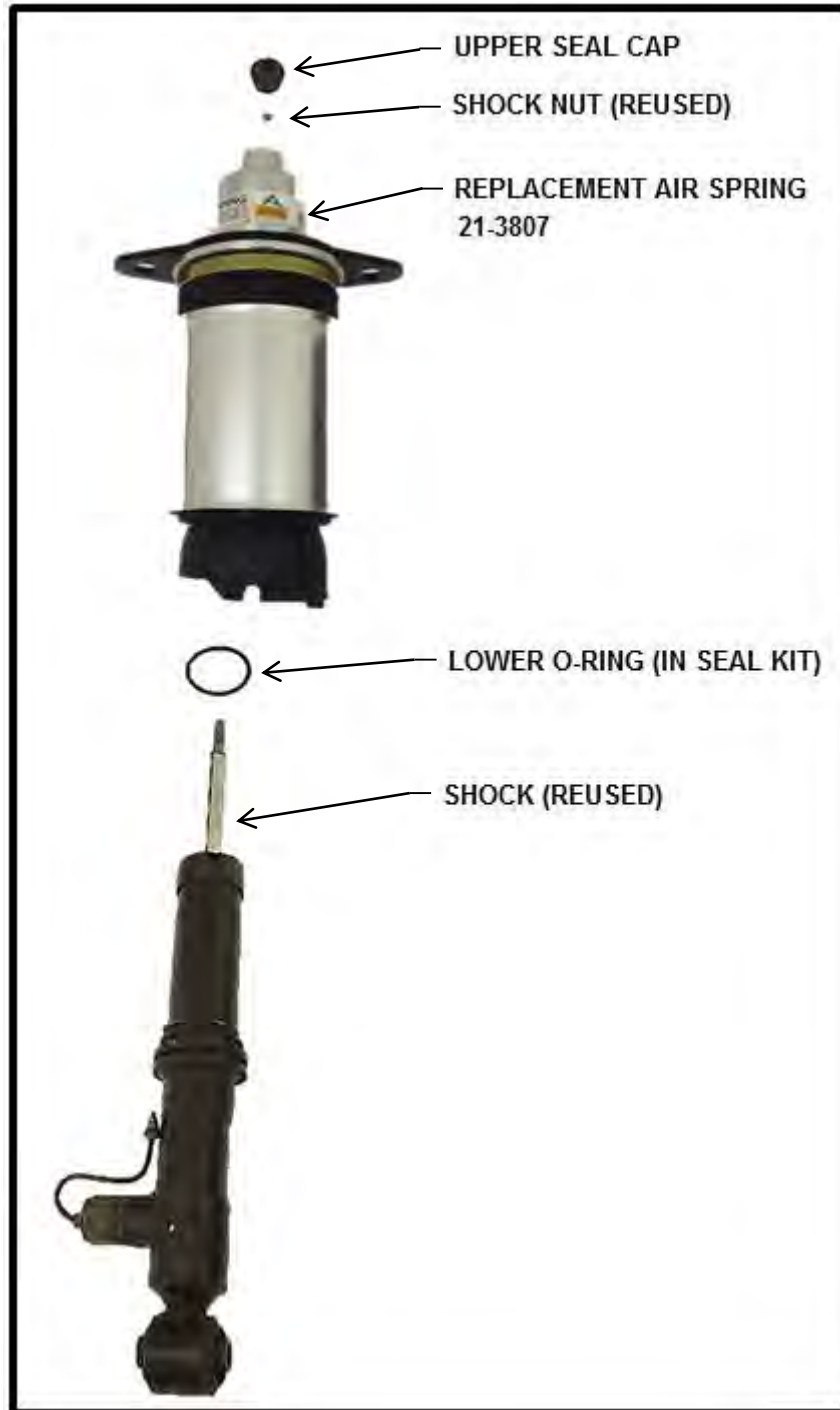



- 4.0 REMOVE AIR PRESSURE FROM REAR AIR SPRING. DEFLATE AIR SPRING BT REMOVING AIR FITTING FROM THE BOTTOM. (FIGURE A & B)
- 5.0 LOOSEN AND REMOVE UPPER MOUNTING BOLTS. (FIGURE C)
- 6.0 LOOSEN AND REMOVE THE BOLT CONNECTING THE SHOCK TO THE LOWER CONTROL ARM. (FIGURE D)
- 7.0 WITH THE SHOCK LOOSE, COLLAPSE THE SHOCK BY PUSHING DOWNWARD ON THE UPPER PLATE TO ALLOW YOU TO DISLOCATE THE UPPER MOUNT FROM ITS MOUNTING PERCH.
- 8.0 PULL THE AIR SHOCK ASSEMBLY UP AND OUT OF THE LOWER CONTROL ARM. (FIGURE E)
- 9.0 THE AIR HOSE CONNECTING THE AIR SPRING TO THE SHOCK CAN NOW BE REMOVED. (FIGURE F)
- 10.0 LOCATED AT THE TOP OF THE ASSEMBLY IS A PLASTIC SEALING CAP, REMOVE WITH AN ALLEN WRENCH. (FIGURE G & H)
- 11.0 BELOW THE PLASTIC CAP IS THE NUT HOLDING THE AIR SPRING TO THE SHOCK. REMOVE THE NUT. (FIGURE I & J)
- 12.0 TURN AIR SPRING  $\frac{1}{4}$  OF A TURN TO DISENGAGE IT FROM THE AIR SPRING PERCH. TAP DOWN ON THE PISTON TO DISLODGE. (FIGURE K)

NOTE: SHOWN IS THE DISASSEMBLED AIR SHOCK. ARROWS INDICATE PARTS REUSED. (FIGURE L)



FIGURE A



FIGURE B



FIGURE C



FIGURE D



FIGURE E



FIGURE F



FIGURE G



FIGURE H



FIGURE I



FIGURE J



FIGURE K



FIGURE L



---

### **REAR SHOCK REINSTALLATION:**

- 1.0 CLEAN AND DRY THE REUSED SHOCK. (FIGURE 1)
- 2.0 REPLACE THE EXISTING O-RING WITH THE NEW ONE SUPPLIED, LUBRICATE WITH NON PETROLEUM BASED LUBRICANT. (FIGURE 1)
- 3.0 REMOVE UPPER SEALING CAP FROM THE NEW SPRING AND INSTALL THE AIR SPRING ONTO THE SHOCK. (FIGURE 2 & 3)
- 4.0 WITH THE REUSED SHOCK NUT, SECURE THE AIR SPRING TO THE SHOCK. TURN AIR SPRING  $\frac{1}{4}$  OF A TURN TO ENGAGE IT ONTO THE AIR SPRING PERCH. (FIGURE 4)
- 5.0 IT MAY BE NECESSARY TO EXTEND THE AIR SPRING TO SEAL AT THE BOTTOM, SQUEEZE THE RUBBER TOWARD THE BOTTOM TO FORCE THE BOTTOM PISTON OUTWARD.
- 6.0 APPLY A LUBRICANT TO THE UPPER SEALING CAP O-RING, THEN REINSTALL THE SEALING CAP AND TIGHTEN. (FIGURE 5)
- 7.0 REINSTALL AIR SPRING ASSEMBLY ONTO VEHICLE.
- 8.0 REINSTALL REAR WHEEL.
- 9.0 INITIALLY LOWER THE VEHICLE SLOWLY, AND ONLY COMPLETELY WHEN THE VEHICLE RISES ON ITS OWN ACCORD.
- 10.0 INSTALLATION COMPLETE.



FIGURE 1



FIGURE 2



FIGURE 3



FIGURE 4



FIGURE 5